

MACHINE GUIDE

Assembly

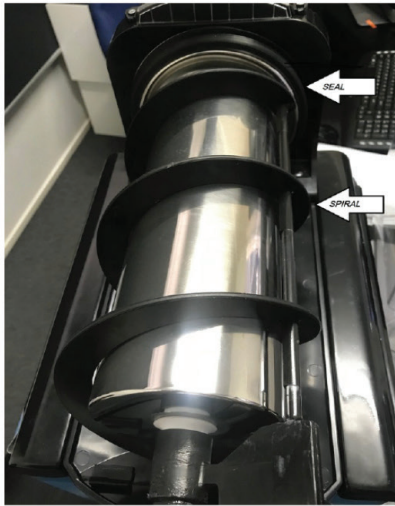

BOWL ASSEMBLY



Lube seal with food grade lubricant and place onto the back of Barrel , push suction cap and spiral into place.

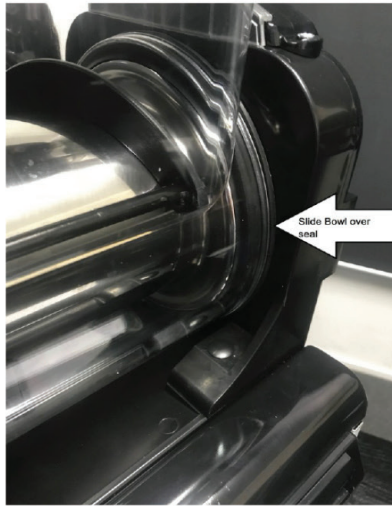

Slide bowl into place over spiral and push over seal on back of machine.



Push downward on both feet and clip into place.

TAP ASSEMBLY



Tap Components



Attach spring to tap pin and push up making sure the whole in pin is facing front, Push up with force.



Insert black handle into tap hole and secure into place with pin into handle.

DRIP TRAY ASSEMBLY

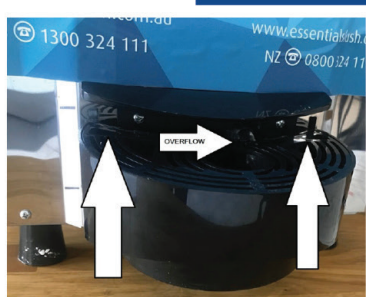
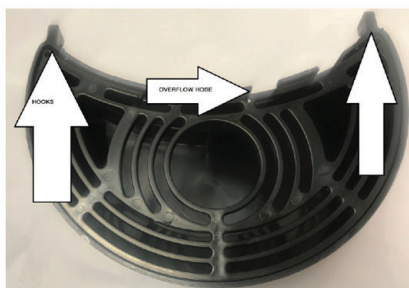

Hook drip tray into each hole and feed the overflow into the slot. Attach lid to drip tray

Empty drip tray when required.

MACHINE OPERATION

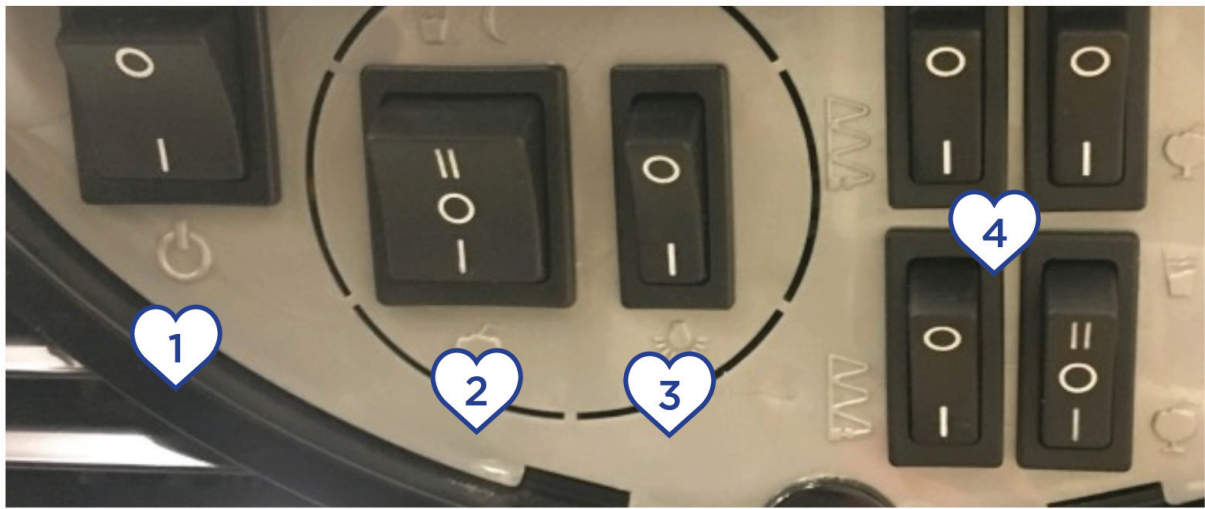

1: MAIN SWITCH
0 = OFF
I = ON

2: OPERATION
II = NIGHT MODE
0 = OFF
I = ON

3: LIGHTS
0 = OFF
I = ON

4: EACH BOWL HAS ITS OWN SETTING

LEFT (Spirals)		RIGHT
OFF	0	OFF
ON	I	ON
	II	NIGHT MODE

ADJUST TEMPERATURE



5



5: Remove small cover on back of machine and move the wheel up or down to adjust the slush consistency.

SLUSH SYRUP

SYRUP RATIO PER BOWL
4:1 = 8 LTR WATER / 2 LTR SYRUP
5:1 = 8.4 LTR WATER / 1.6 LTR SYRUP
*Never use a different ration or place water only in Bowl while on.



Minimum / Maximum Fill lines on bowl